

A man is surfing on a wave in a water park. He is shirtless and has a focused expression. The water is splashing around him. In the background, there are palm trees and a thatched roof structure. To the right, there are colorful surfboards lined up. The overall scene is vibrant and energetic.

~~~~~

# EXPERIENCE

## THE WAVES & RIVERS

~~~~~



PolinWaveParks by



PolinWaterparks

THE EXPERIENCE

EXPERIENCE THE WAVES & RIVERS

We are committed to delivering experiences with the feeling of real waves. Creating ideal conditions for surfing in a safe and controlled environment, any time of the year, anywhere in the world is not rocket science because we have ground-breaking technologies, innovative perspective and a dedicated team of experts.

The fact that most of our clients are repeat customers demonstrates our commitment to provide them with an excellent service, innovation and finest quality & long-lasting products every time.

We generate waves that will ensure hours of fun and laughter for your guests. We are engineered for durability, ease of operation, maintenance, safety and of course, fun. Polin has perfected hundreds of exclusive and successful projects all around the world with that attitude.

ABOUT THE EXPERIENCE

The rush of water. The surge of adrenaline. The flow of energy. The screams of joy. You can't describe it. You have to feel, experience it.

Polin has been doing what she is doing with that same feeling of anticipation and energy for nearly 40 years. Committed to safety and passionate about design, we've grown from a family company into a global leader, with 2500 waterpark projects in 100 countries worldwide. We're proud to offer the industry's widest range of waterpark and water play attractions.

In time, passion became profession.

Our pioneering technologies and ground-breaking designs mean that we are the trusted suppliers to some of the world's biggest, award-winning waterparks. We understand that each and every element within the waterpark matters and our thrilling waterslides help break attendance records for our clients all over the world.

What we don't like the most is paper talk.

It's this attention to detail and desire for perfection that guarantees the quality and variety of our rides and ensures that every waterpark we work with delivers a unique experience.

Game changing innovations such as our landmark King Cobra or L-RTM technology in waterslide manufacturing have set new industry benchmarks for creativity and excitement.

Where there is fun there is joy, there is absolute perfection.

You are invited to experience, The Polin Experience.

Polin Waterparks,
The Experience.

EXPERIENCE THE WAVES & RIVERS

6 THE WAVE BALL

9 Product Range

11 Advantages

14 SURF STREAM®

22 Technical Specifications

26 WAVE POOLS

29 Technical Specifications

30 Water Freefall System

31 Wave Systems

33 Round Wave Pool

34 Surf & Wave Pool

35 Wave Patterns

36 RIVERS

38 Lazy River

42 Crazy River

43 Rafting River

44 Torrent River

45 Junior River

46 Lazy River with Splash Toys

47 VR Game Animation Alternatives in Lazy & Dark Rivers

48 Dark River with Shooting Game

50 Special Themes for Rivers & Waves

EXPERIENCE THE WAVES

THE WAVE BALL





THE WAVE BALL

Strategic Alliance

WOW Company and **Polin** have announced a strategic alliance to deliver even greater value to their clients. **Polin** is the exclusive distributor of the original **WOW Wave Ball** for Maghreb, Balkans, Middle East and the Commonwealth of Independent States and Baltic countries.

The Wave Ball, The Intelligent Wave Generator

Despite its simple appearance, **The Wave Ball** is a high technology product. Several sensors combined with software/hardware efficiently allow the Wave Ball to produce and increase the waves with a full control of the frequency, the amplitude and the model of waves. The Wave Ball is the application result of three working physical principles: **The Archimedes' principle** that allows the Wave Ball floating on the pool. **The action-reaction principle**: A movable load moves upwards inside the shell. As the Wave Ball is placed in water, the shell moves up and down. And finally, **the principle of resonance**: the energy given to the pool is kept in the pool thanks the freeboards. At each time that the Wave Ball transmits its energy to the pool, the waves are becoming bigger.

WOW Company Rides The Crest Of The Wave

WOW Company is specialized in low consumption, safe and reliable wave generators and has developed over 300 projects in 47 countries since 1991. WOW Company is the inventor and sole manufacturer of the well known **Wave Ball**. WOW Company is a business unit of WOW group which counts with highly skilled engineers who develop state of the art automated machines in many sectors.



Please contact us at waves@polin.com.tr and visit www.wowcompany.com for further information.



Wave Height 40 cm	Model		Area (m ²)	
		W105FL	60	W105F
	W130FL	170	W130F	250
	W150FL	300	W150F	400
	W165FL	520	W165F	600
	W180F	800		

Wave Height 60 cm	Model		Area (m ²)	
		W105FL	45	W105F
	W130FL	130	W130F	200
	W150FL	230	W150F	300
	W165FL	400	W165F	450
	W180F	600		

Wave Height 80 cm	Model		Area (m ²)	
		W105FL	30	W105F
	W130FL	80	W130F	120
	W150FL	150	W150F	200
	W165FL	250	W165F	300
	W180F	400		

PRODUCT RANGE

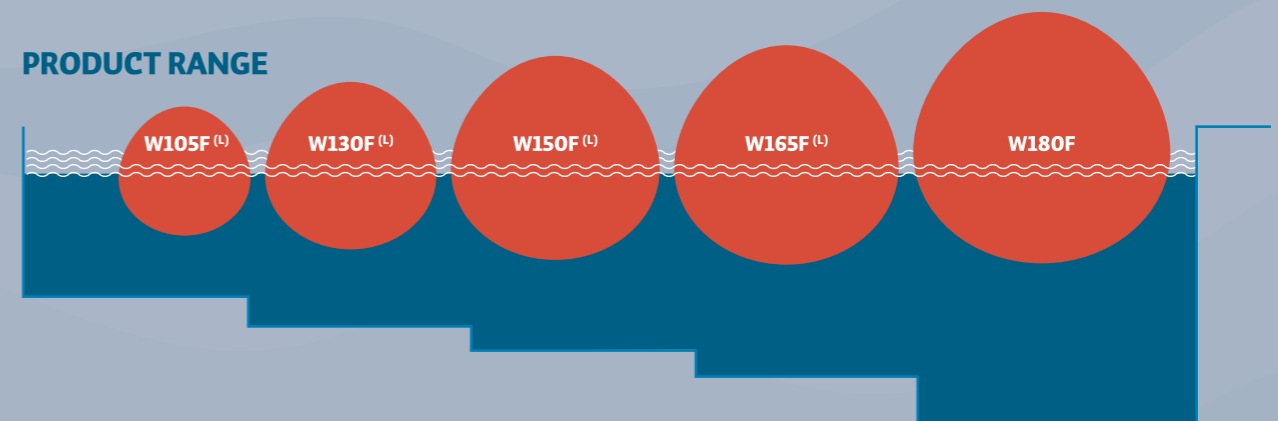

WAVEBALL MODEL	W105FL	W105F	W130FL	W130F	W150FL	W150F	W165FL	W165F	W180F
Weight (kg)	180	210	330	420	500	580	780	180	1080
Diameter (cm)	105	105	130	130	150	150	168	165	180
Maximum Power (kW)	0.5	0.7	0.9	1.5	1.7	1.9	2.5	3.0	4.5
Minimum depth at the location of the ball (cm)*	110	140	125	150	140	160	150	170	180

* The minimal depth has to be respected 3 meters around the anchor point.

- For an optimum use and based on the depth of the swimming pool at the location of the Wave Ball, our team will choose one of the nine available models F and FL.
- The height of the wave is measured from crest to trough.
- 80 cm is not a limit, waves over 1 m can be reached.



Ride It for Awesome Rodeo Sessions

From the W150FL intermediary Wave Ball model, a saddle can be mounted on the shell. The saddle allows the swimmers to ride the Wave Ball with a special "rodeo" wave mode and the wave generator becomes a unique experience and the most attractive play of your project...

Ride the waves!

For Any Kind of Shapes of Pools

Rectangular, circular, free shape, shell shape, snail shape. The Wave Ball can be implemented in almost every kind of shape of pools and WOW Company can also create new customized and exclusive shapes like the bean wave pool or the guitar wave pool.

Customization

The Wave Ball can also be a significant communication asset for your project. You can choose one of the standard colors or to personalize with any kind of RAL colors available. Moreover, you can add your logo, your website, a specific logo of the brand of a partner on the shell. Vectorial files of the drawing / logo have to be supplied for that. Thanks to our last innovation, you can personalize completely the Wave Ball with characters or with a special design like the Shark Ball on your right.



Advantages



The Wave Ball is a Wave Generator



Designed and Made in Belgium



Ecological Low Consumption (0.5 => 4.5 kW)



Easy Installation in 2 Days Only



For New and Existing Pools



No heavy, expensive and soundproof machinery room



Generates different patterns and sizes of waves



Safe & Fun



You can ride it for some awesome rodeo sessions



For any kind of shape and surfaces of pools (from 35 sqm)



Hagymatikum **Hungary**
W130FL



Lipóti Termálfürdő **Hungary**
W150FL



Oasis Village **France**
W150F



Bahay Ni Kuya Resort **Philippines**
W130FL

The Wave Ball: A Powerful and Proven System

The Wave Ball is a floating sphere on the water, which generates safe and controlled artificial waves allowing a very playful swimming.

It animates leisure pools in amusement parks, public swimming pools, recreational centers, wellness centers, campsites, but also marine tanks and Rescue and Survival training centers.



Aquatica Epe Sauvage **France**
W130FL



Noah's Leisure Park Resort & Hotel **Philippines** W130FL



Erzsébet Spa **Hungary**
W150FL



Green Nature Resort **Philippines**
W130FL



Holiday World Resort **Spain**
W180F



Paraiso ni Baste Resort **Philippines**
W150F

The Wave Ball: A Must for Your Pool

From small ripples to powerful waves, the Wave Ball transforms the calm water into a rough sea or a raging ocean in just a few minutes! The Wave Ball can also be customized to correspond perfectly to your project and brand image. This is a wonderful waves generator that brings pleasure for young and old. The Wave Ball is a fantastic element to increase the popularity and hence the public of equipped pools by up to 30%. It is ideal for water parks, hotels, resorts, camping pools, wellness, public pools, aquariums, animal parks and even rescue and survival training centers. The Wave Ball has been installed in over 300 projects in 47 countries around the world.

EXPERIENCE THE WAVES

SURF STREAM[®]



SURFSTREAM®

Global Waterpark Designer to Align with Out-of-Ocean Surfing Leader

American Wave Machines and Polin have announced a strategic alliance. As of November 2015, Polin became an exclusive global distributor for American Wave Machines in the burgeoning waterpark market.

With surfing as the most aspirational sport, this partnership provides Polin the ability to design surf parks within their waterparks, opening up the coveted surfing demographic to their clients. The partnership provides clients with unique waterpark designs, competitive pricing, and fast turnaround. The partnership also improves service across the board and expands product offerings.

AWM Already Has a Strong Relationship with Polin

Polin Resin Transfer Molding Technology has been the backbone of SurfStream®, the only surfing machine fabricated with high quality FRP, which creates multiple standing wave types and sizes all in one machine. The partnership expands the offering to include PerfectSwell® wave pool systems, the first and only air-pressure system to create naturally occurring ocean swells for an authentic world class surfing experience.



More on American Wave Machines

American Wave Machines is the world's leading wave pool, surf park and wave technology company producing authentic surf experiences. SurfStream® 5-15K square foot venues have capacity in the 100's while PerfectSwell® surf pools and surf parks are 1 acre plus with capacity in the 1,000's. Since 2007 over 3,000,000 surf sessions have been enjoyed at American Wave Machines locations around the globe.

WHY AMERICAN WAVE MACHINES

American Wave Machines is Safe

You can breathe easy knowing your guests will experience the thrill of surfing safely because of our meticulously chosen materials and our outstanding safety record.

American Wave Machines is Unique

Our wave systems aren't your typical theme-park ride. Guests are participating in an athletic activity and encouraging onlookers to participate as well.

American Wave Machines is Authentic

Real surfboards, real fins and real riders make ours the most authentic out-of-ocean surfing experience around.

American Wave Machines is Patented

Our proprietary designs and technology are the safest and most innovative in the industry. The competition can't provide a safer and more innovative system.



AMERICANWAVEMACHINES

EVERYONE CAN SURF

Any wave type and size can be accomplished with American Wave Machines' proprietary technology allowing for endless possibilities.



MULTIPLE WAVE TYPES CREATE PERFECT CONDITIONS FOR RIDERS OF ALL SKILL LEVELS.

STANDING WAVE TECHNOLOGY

- Deep water - ride real surfboards
- Small footprint - starting at 1000 ft². 100 m²
- Customizable design (Lighting, color and size)
- Modular components for multiple wave types: Party waves (Up to 12 simultaneous riders on the SS6032), training waves (Perfect for beginners, surf lessons and bodyboarding), deep water standing waves (Advanced surfing) and barreling waves (Intermediate to advanced surfing)
- Multi-rider capability - high throughput
- Beginner to advanced surfing in one system
- State of the art programmed controls for various riding modes and water speeds.
- Multiple sport options (Surfing and bodyboarding)

Scope of work and is done so under U.S. Patents 5.236.280: 6.019.547: 6.336.771: 6.629.803: 6.932.541: 7.326.001: 7.568.859: 7.658.571: 7.815.396: 7.722.291: 8.303.213: 8.434.966: 8.523.484. with other U.S. and international patents pending.





IMAGINE CALLING UP YOUR FAVORITE WAVE FROM THE SHORE WITH YOUR IPAD OR FROM YOUR BOARD WITH YOUR IPHONE - GENTLE OR HOLLOW, SMALL OR LARGE.

ADVANCED PNEUMATIC SURF GENERATING TECHNOLOGY

- The most versatile system
- Specified based on desired size, type of surf, and ride length
- From 2.000 ft²- 100.000 ft² + (465 m²- 9.300 m² +)
- Adjustable wave heights (1' - 10'+ / 3 m- 3 m+), peel angles and break points and take off points
- Replicates reefs, beach breaks, and point breaks
- Real ocean wave dynamics
- Natural surf frequency every 5 - 10 seconds, multiple wave sets
- Multiple wave zones simultaneously operating
- Create continuous surf, no wait time between waves
- Multiple sport options (Surfing, bodyboarding, swimming, SUP)

Scope of work and is done so under U.S. Patents
5.236.280: 6.019.547: 6.336.771: 6.629.803:
6.932.541: 7.326.001: 7.568.859: 7.658.571:
7.815.396: 7.722.291: 8.303.213: 8.434.966:
8.523.484: 9.279.263 with other U.S. and
international patents pending.





TECHNICAL SPECIFICATIONS



SELECT MODE FOR MAX. YIELD



SURFSTREAM®				
	Model SS4012	Model SS4016	Model SS6024	Model SS6032
SIMULTANEOUS RIDER CAPACITY	2 SURFERS 5 BOADYBOARDERS	3 SURFERS 6 BOADYBOARDERS	5 SURFERS 10 BOADYBOARDERS	7 SURFERS 12 BOADYBOARDERS
OVERALL SYSTEM FOOTPRINT	22X52 ft 6.7x15.8 m	26X57 ft 7.9x17.4 m	34X62 ft 10.4x18.9 m	40X67 ft 12.2x20.4 m
AVG POWER RANGE	45 KW - 140 KW	60 KW - 330 KW	90 KW - 360 KW	120 KW - 495 KW
WAVE HEIGHT	2.5 to 3.3 ft .75 to 1 m	2.5 to 4 ft .75 to 1.2 m	2.5 to 6 ft .75 to 1.8 m	2.5 to 6 ft .75 to 1.8 m
TOTAL WATER REQUIREMENTS	38.000 Gallons	42.000 Gallons	80.000 Gallons	115.000 Gallons

SURFSTREAM®		
	Model SS3008	Model SS5020
SIMULTANEOUS RIDER CAPACITY	1 - 3 BODY BOARDERS	1 - 9 BODY BOARDERS OR SURFERS
OVERALL SYSTEM FOOTPRINT	5.4x16.2 m	9x18.9 m
AVG POWER RANGE	(3 phase, 4 wire, 380V-480V, 50-60 Hz)	(3 phase, 4 wire, 380V-480V, 50-60 Hz)
WAVE HEIGHT	75 to 1 m	75 to 1.5 m
TOTAL WATER REQUIREMENTS	27.500 Gallons	66.000 Gallons

ALL POOLS DESIGNED TO MAXIMIZE SITE YIELD

PERFECTSWELL			
	SMALL	MEDIUM	LARGE
NO. OF 10ft (3.3 m) CHAMBERS	9	18	36
AVG POWER RANGE	149 kW - 298 kW	298 kW - 930 kW	596 kW - 1860 kW
PER HOUR POWER COST	\$14.9 - \$29.8	\$29.8 - \$93	\$59.6 - \$186
WAVE SIZE	1 ft - 8 ft .3 m - 2.43 m	1 ft - 10 ft .3 m - 3 m	1 ft - 10 ft .3 m - 3 m
NUMBER OF RIDERS	120 - 540 Max per hour	240 - 1080 Max per hour	480 - 2160 Max per hour
WAVE FREQUENCY	Continuous Surf - No waiting for Waves	Continuous Surf - No waiting for Waves	Continuous Surf - No waiting for Waves
EXAMPLE POOL SIZE RANGE	9.700 ft² - 18.000 ft² 900 m² - 1.700 m²	27.000 ft² - 54.000 ft² 2.500 m² - 5.000 m²	45.000 ft² - 97.000 ft² 4.200 m² - 9.000 m²

THE OPPORTUNITY

From conceptualization to operation American Wave Machines makes it possible to deliver authentic surfing experiences outside of the ocean in a surf park that are highly profitable on a pay-for-surf model.

We are unique within the surf park industry and the only company with direct conceptual design engineering, supply installation, and operational experience for every currently available wave technology category. We are experts in all types of wave and surf pools as well as overall surf park design with an extensive IP portfolio. Our success rate is %100.



THE POSSIBILITIES ARE ENDLESS

American Wave Machines adds economic value to your facility by creating new revenue streams.



POTENTIAL BENEFITS INCLUDE

- Diversify from other globally recognized resorts
- Competitive surfing leagues and contests
- Sponsorships and brand partnerships
- Surf coaching (HPC) and athlete development
- Equipment and Gear testing facility
- Fitness facilities and classes
- VIP zones (hot tubs, private cabanas and tiki bars)
- Night attraction
- Reputation as a world class surfing destination
- Enhances guest occupancy and loyalty
- Wave pool passes
- Automated video and photography system
- VIP board riders club and personal storage
- Surfboard demos and equipment rentals
- Surf themed food and beverage
- Large scale events

AMERICANWAVEMACHINES

Please contact us at waves@polin.com.tr for further information.



EXPERIENCE THE WAVES

WAVE POOLS





WAVE POOLS

WAVES OF ALL TYPES

- The whole family time
- The relaxing vs. The excitement time
- The wild swimming time
- The source of joy Water sunbathing
- Interactive adventure
- Interactive adventure
- Wide wave variety
- A real “beach day”
- Feels like an ocean
- Inspired by nature

New Generation Wave Pool systems are engineered for durability, ease of operation and maintenance, safety and of course lots of fun. We generate waves that will ensure hours of fun and laughter for your guests by turning the pool into an ocean for swimmers.

Nowadays, pools are not only for swimming. They are now the source of joy with different kinds of activities. Wave pool becomes a must feature in every aqua park, designed in accordance with the theme of the park and guest profile is a guarantee for success.

An example new generation wave pool is 12 meters width and 25 meters long has 4 air chambers producing different variation of waves in terms of height and its type. For instance if air is given from all chambers the pool produces 80 cm smooth waves, whereas if the system is programmed for random or periodical action of pneumatic valves, it produces waves of different sizes from 80 to 110 cm.

New wave generator solutions are developed by the Research & Development Department team and are implemented successfully, being wave pool producer for more than 500 successful projects worldwide, with a large geography of references. Taking into consideration that customer satisfaction is crucial, we develop solutions which are absolutely economical by means of both fixed cost and efficiency.

New generation wave pneumatic valves system delivers air to the air chamber by fully automatic PLC control unit, thus creating the pressure on the water surface. Utilization of this system requires less energy than in similar systems.

NEW GENERATION WAVES

- Wave height: Variable to 1.0 m (3'-3 4/10" ft)
- Wave patterns: Diamond & Double Diamond, Parallel & Half Parallel, V & Inverted V, Left and Right Diagonals
- 10 Years of Experience
- Constant Research for Development
- Innovation for Joy
- Pool Size: 135 m² - 4,650 m² (1,450 ft² - 50,000 ft²)
- Best Quality Machines
- Proven Technology
- Approved Standarts
- To create optimum wave form
 - Computer controlled system,
 - Special air tube & wave chamber design,
 - Usage of CFD Analysis at design stage.
- Optional Remote Control
- Adjustable start and stop times according to the preset time table.
- High frequency wave production capability (1 Hz)
- Up to 1,2 m height in line wave form

TECHNICAL SPECIFICATIONS

WAVE TYPE	POOL SIZE	WAVE GENERATING SYSTEM	POOL BASE SHAPE	WAVE STAGES	WAVE HEIGHT	WAVE PROGRAMING COMPUTER	WAVE FREQUENCY	POWER CONSUMPTION
"OCEAN WAVES COMBINED WITH FUNNY WAVES"	FROM 3000 m ²	"WATER FREEFALL SYSTEM &		FROM 12 STAGES	UP TO 3.2 m / UP TO 1 m	"3 SECTIONAL RANDOM WAVE OR LINE WAVE.	15 sec - 60 sec / 1 sec - 20 sec	FROM 250KW + 185KW
FUNNY WAVES	FROM 400 m ²	AIR PREASURED SYSTEM "		FROM 3 STAGES	UP TO 1.2 m	RANDOM WAVE GENERATING TIMING.	1 sec - 20 sec	FROM 45KW
LONG BEACH WAVES (NEW)	FROM 2500 m ²	AIR PREASURED SYSTEM		FROM 8 STAGES	UP TO 1.2 m	FULLY PROGRAMABLE"	1 sec - 20 sec	FROM 245KW
JUNIOR WAVES	FROM 400 m ²	AIR PREASURED SYSTEM		FROM 3 STAGES	UP TO 80 cm	FULLY PROGRAMABLE	1 sec - 20 sec	FROM 37KW
RAFTING RIVER WAVES	FROM 200 m	AIR PREASURED SYSTEM		2 STAGES	UP TO 1.2 m	FULLY PROGRAMABLE	1 sec - 20 sec	FROM 45KW
RAPID DRAGON WAVES	FROM 200 m	AIR PREASURED SYSTEM		2 STAGES	UP TO 1.5 m	FULLY PROGRAMABLE	1 sec - 20 sec	FROM 45KW



WAVE SYSTEMS PNEUMATIC SYSTEMS

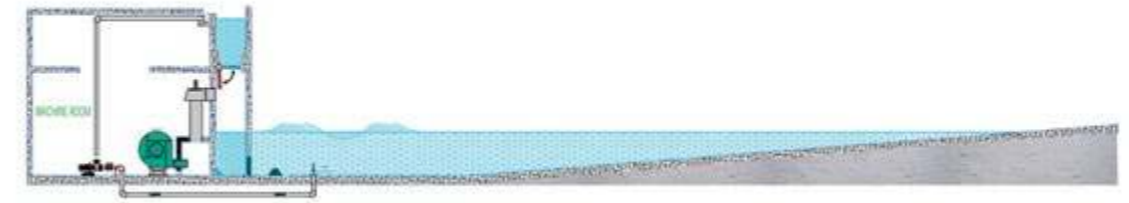

WATER FREEFALL SYSTEM (COMBINE WITH PNEUMATIC SYSTEM)

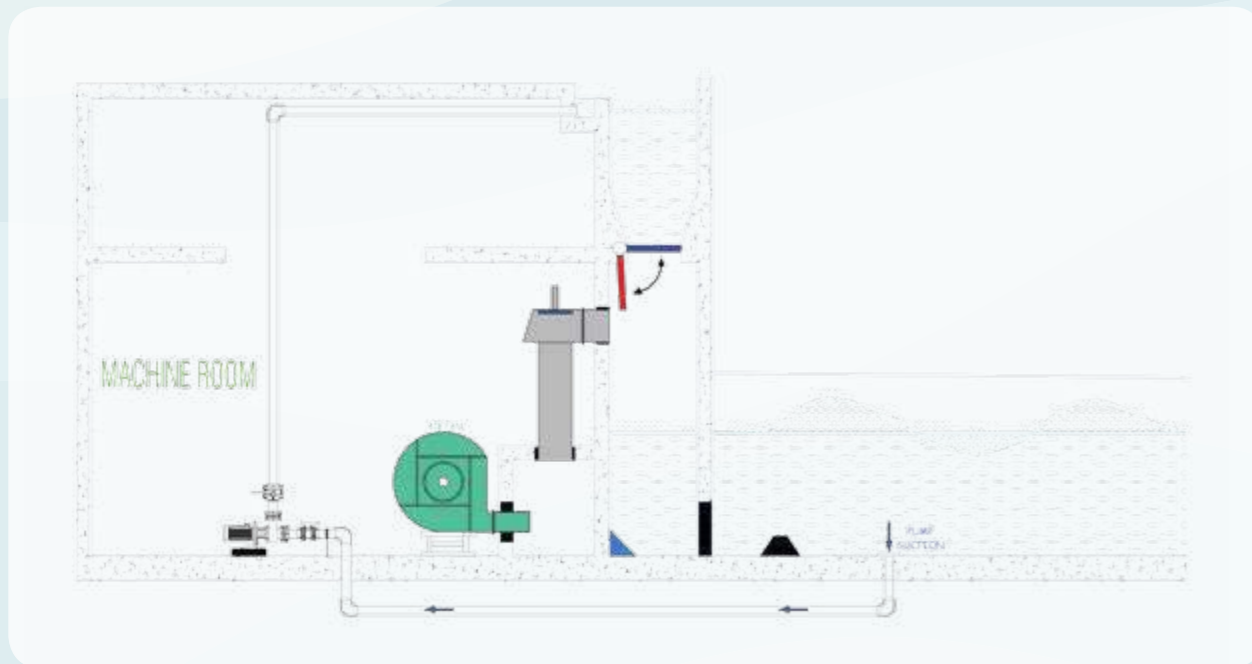

Please contact us at waves@polin.com.tr for further information.

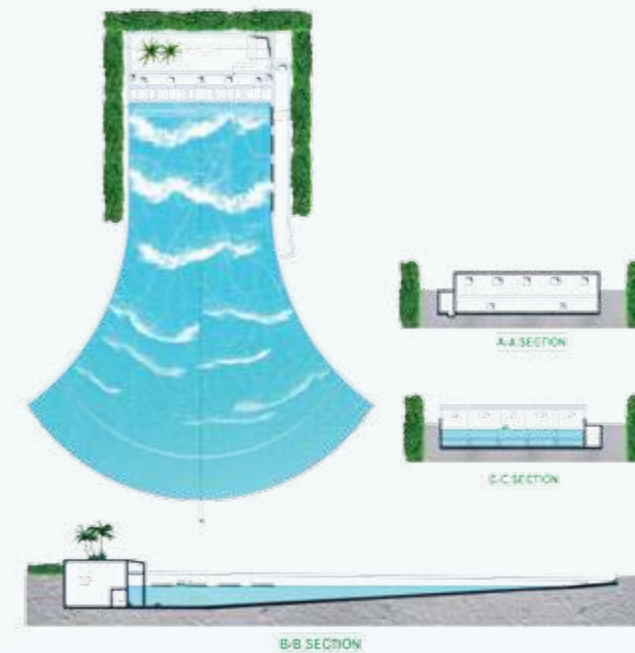



The Land of Legends Theme Park
Antalya, Turkey

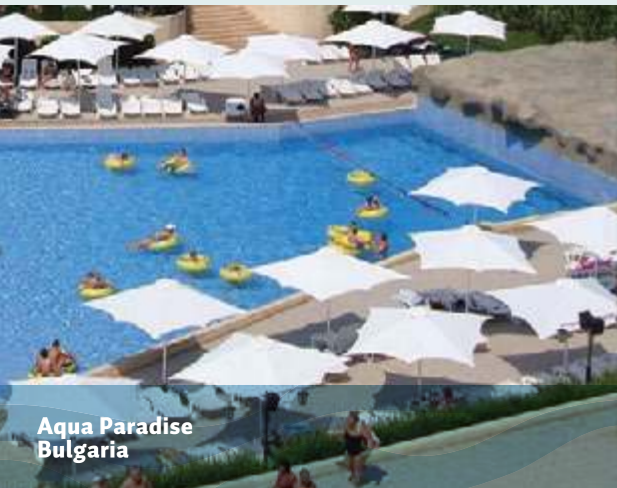

Aqua Paradise
Bulgaria



Kahya Otel
Antalya, Turkey



Jungle Aquapark
Kharkov, Ukraine



Vinpearl
Nha Trang, Vietnam

ROUND WAVE POOL

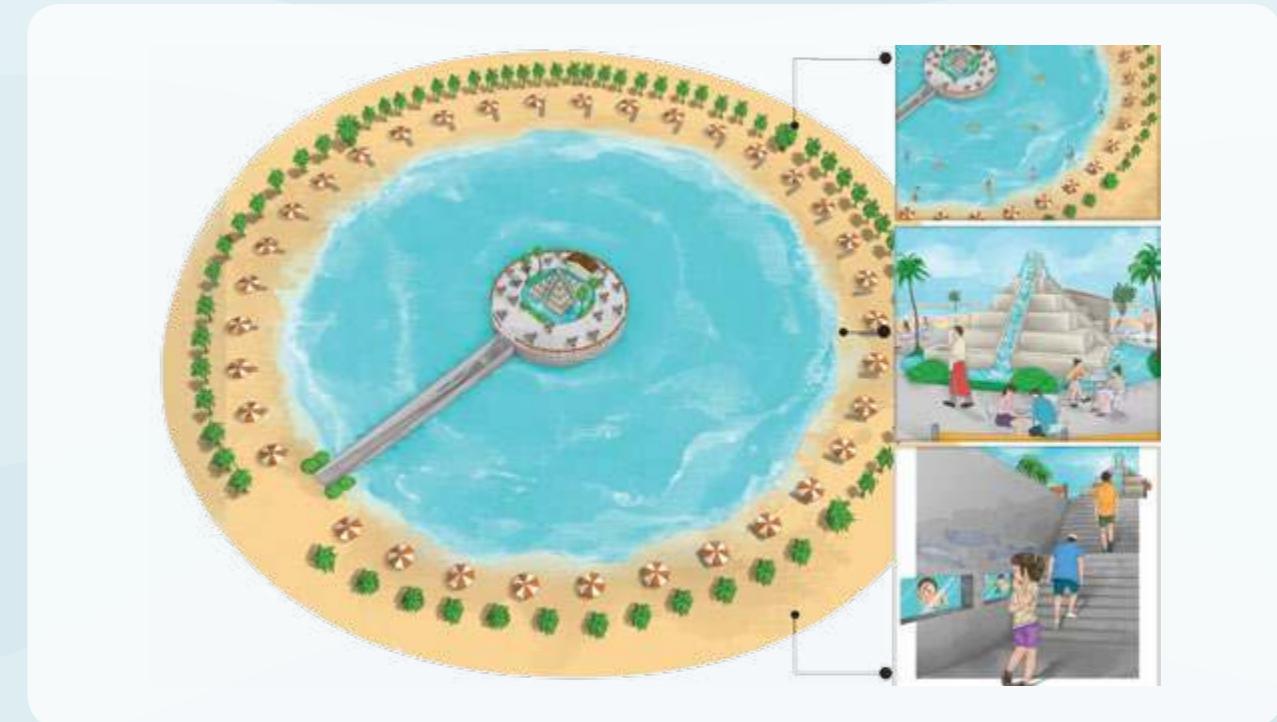
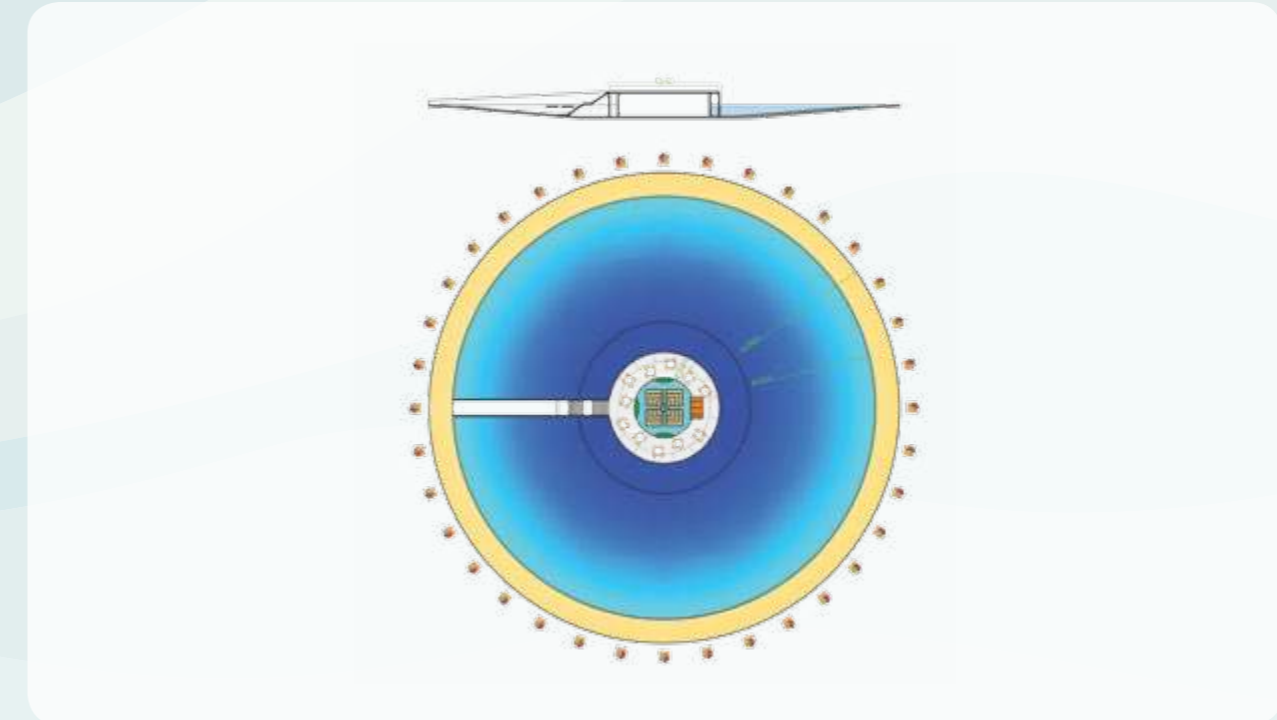

SURF & WAVE POOL

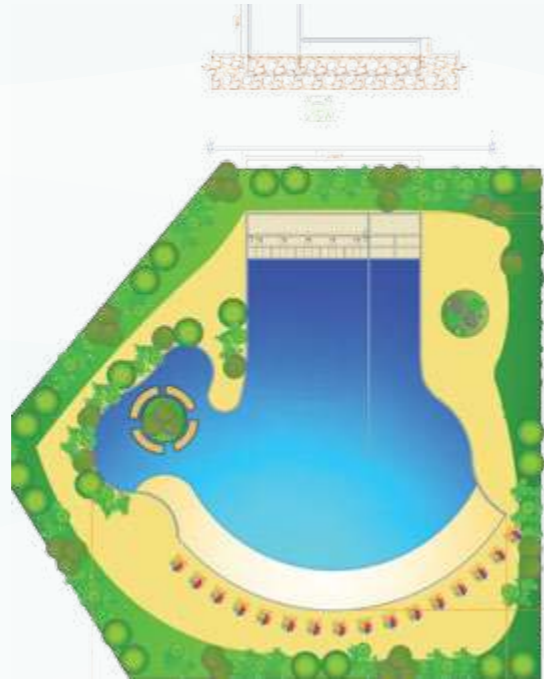

WAVE PATTERNS



Line Waves

One of the basic and most popular wave types.
All of the pistons work at the same time with same time intervals which results into the creation of long line waves parallel to the beach.
The length of the wave is equal to the present width of thy wave pool.
The way to have fun / Customer satisfaction

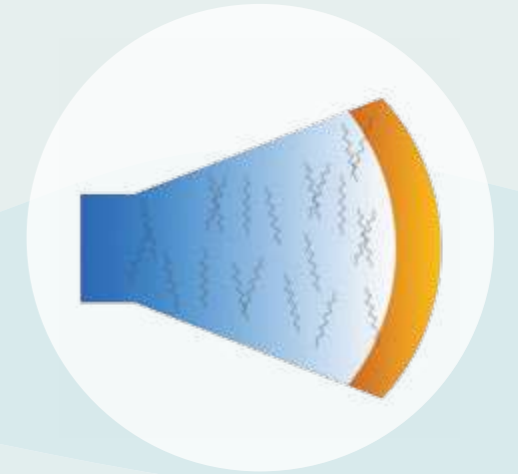

Mixed Waves

Easiest waves to programme.
Mixed waves have infinity number of patterns.
All of the time periods for each wave chamber are generally different which creates chaotic funny waves in different areas of the wave pool.



Left Sided Waves

By programming to work only left or right air chambers of the wave machine we are able to send the ways in one directions only. These programme type is also know as economy type programme as it operates only half capacity of the wave machine.



Right Sided Waves

By programming to work only left or right air chambers of the wave machine we are able to send the ways in one directions only. These programme type is also know as economy type programme as it operates only half capacity of the wave machine.

EXPERIENCE THE RIVERS

RIVERS

ADVANTAGES OF OUR RIVERS

- Special pumps are most suitable specific speed to reach most effective flow speed of the river. So they have 70% less energy consumption according to centrifugal type pumps.
- Special pumping system needs less installation area than other alternative systems. So transportation cost can be minimized.
- Fast installation and commissioning with packet system.
- Adjustable flow speed with inverter technology.
- Concrete works have less cost than other alternative systems.
- Worldwide technical services for used equipment.
- Ease of operation and maintains with the simple system.



LAZY RIVER

RELAXING JOURNEY

- Gentle Ride Along River
- With the natural theme
- Truly unique pool scape
- Flexibility in controlling
- Stylish and class
- Best Possible Solutions

“The Lazy River” is a fun and a relaxing journey to get around the park with lots of surprises for the lazy days of your holidays. It is a non- traditional park visit by floating leisurely down.

In some large aqua parks, the length of the river reaches up to 750 m, where it is great pleasure to have conversation in a relaxed atmosphere finding yourself in a boat in the middle of the river. Due to high power consumption some aqua park managers keep the Lazy River short, but Atlantis Pool offers its customers the best efficiency solution, keeping length of the river long with the help of special engines that increase the water inversion capacity.

Lazy river is a mechanical system maintaining a ring-shaped artificial river not exceeding 1.20 m depth, flow in one direction with a speed of 0.5 m/sec to 1.5 m/sec. Atlantis Pool using a special high-efficiency propellers creates a movement of water with a small number of engines. As an example is Aquatarin Waterpark in Iraq / Erbil, one of the largest outdoor water parks in the Middle East having a lazy river of 750 m long. Generally such a river is operated by 300 kW energy consumption, where Atlantis Pool engineers solved the system with only 90 kW consumption, giving the 1.5m/sec speed to the 4000 m³ river, breaking our own record.

A RELAXING DAY

- Work type: Mixer Thrusted
- Flow speed: 0,5 - 1,5 m/s
- Keeps you cool
- High-efficiency propellers
- More active resting
- With all family members

	RIVER LENGTH (m)	RIVER WIDTH(m)	DEPTH (m)	WATER SPEED (m/sec)	GROSS POWER (kW)
LAZY RIVER V1	60	2.5 - 3	0.8 - 1.0	0.5 - 1.0	5.5*
LAZY RIVER V2	70	3.5 - 4	1.0 - 1.2	1 - 1.5.0	10**

For each 60 meters. *
For each 70 meters. **



The Land of Legends Theme Park
Antalya, Turkey



The Land of Legends Theme Park
Antalya, Turkey



Evpatoria
Ukraine



Bataysk
Russia



Bataysk
Russia



Aqua Paradise
Bulgaria



Jogja Bay Pirates Adventure Waterpark
Indonesia



Santorini Water Fantasy
Cha-am, Thailand



Evpatoria
Ukraine



CRAZY RIVER

So you don't like being lazy? You get bored when you're moving along slowly in a boat? Instead of the peaceful flow of a lazy river, here's a river that runs crazy just so you can test your performance. You can leave yourself to the natural flow of the river or try to swim against the current, but even walking against the current will entertain you.

	RIVER LENGTH (m)	RIVER WIDTH(m)	DEPTH (m)	WATER SPEED (m/sec)	GROSS POWER (kW)
CRAZY RIVER	20	2.0 - 3.5	0.8 - 1.0	2.0 - 2.5	10*

For each 20 meters. *



RAFTING RIVER

If you want to fight with strong bubbles, waves and if you don't mind falling and getting wet try "Wave River". We guarantee that you will love it. Such pools that are designed in accordance with the theming of the park and the guest profile guarantee the success of your park. Rafting, one of the exciting outdoor sports which now can be enjoyed in aqua parks also. It can be experienced with in various levels of difficulty by adjusting the flow speed and wave patterns in artificial rivers.

	RIVER LENGTH (m)	RIVER WIDTH(m)	DEPTH (m)	WAVE LENGTH (m)	GROSS POWER (kW)
RAFTING RIVER	100	2.5 - 5.0	0.8 - 1.2	0.5 - 1.0	55*

For each 100 meters. *



Aquamania
Albena, Bulgaria



TORRENT RIVER

As you move along in the calm flow of the river, you'll experience the thrill of a wave that will suddenly throw you off balance. You will follow the interspersed waves and become one with the giant swells. An exciting journey that will shoot your adrenaline up to the limits is waiting for you.

	RIVER LENGTH (m)	RIVER WIDTH(m)	DEPT (m)	WATER SPEED (m/sec)	WAVE LENGTH (m)	GROSS POWER (kW)
TORRENT RIVER	100	2.5 - 4.0	0.8 - 1.0	4.5 - 8.0	0.5 - 1.0	100*

For each 100 meters. *

JUNIOR RIVER

Would you like a shallow and lazy river that your kids can play in safely? Splash toys can also be added to this product. This way, while your kids are safely moving around in the river, you can play with them by splashing them with splash toys.

	RIVER LENGTH (m)	RIVER WIDTH(m)	DEPTH (m)	WATER SPEED (m/sec)	GROSS POWER (kW)
JUNIOR RIVER	20 - 30	1.5 - 2.0	0.25 - 0.4	0.4 - 0.6	2.5*

For each 20 meters. *





LAZY RIVER WITH SPLASH TOYS



VR GAME ANIMATION ALTERNATIVES IN LAZY & DARK RIVERS

We designed different splash features for the Lazy River to add a little more action, excitement and interactive play to the peaceful environment. These are:

- The overturning pail,
- The water curtain,
- The daisy shower,
- The water gun / water cannon,
- Laminar flow nozzles.

So you don't like to remain inactive in Lazy River? With special water-resistant VR goggles, you can convert your environment into an entirely different virtual reality (Amazon River, Jungles, Space, etc.). At the same time, making use of the goggles' motion, you can play an exciting game of hit the target. The targets, depending upon the theme selected, may be a spaceship or crocodiles in the river.



DARK RIVER WITH SHOOTING GAME

This is a much more interactive and entertaining game that adds a new dimension to the attraction of Dark River. It features different theme alternatives for Dark River as well as an exciting bull's-eye game played with a LED pistol, making it popular among both adults and children. Users shoot their LED pistols at the targets that suddenly appear before them during their trip on specially designed rafts that seat 2 - 4 persons. After each bull's-eye, a special loudspeaker and light system help to celebrate the moment. Hitting the target also wins users points, creating an atmosphere of entertaining competition. Highest scores are recorded on a daily, weekly and monthly basis.

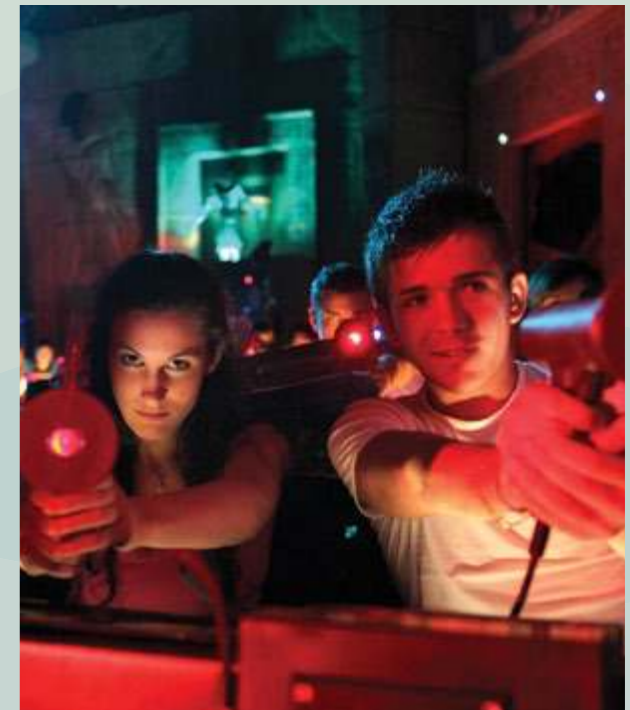

SPECIAL THEMES FOR RIVERS AND WAVES





PolinWaveParks



Polin Waterparks T +90 262 656 64 67 F +90 262 656 64 75 M +90 532 443 80 23 Gebkim OSB Refik Baydur 6 41480 Dilovasi / Kocaeli, TURKEY

waves@polin.com.tr

polin.com.tr      polinwaterparks